



Filter Disassembly & Assembly

Cleaning/Removing Cartridge Element

NOTICE: An indication that the filter needs cleaning is when the pressure gauge rises 5-7 PSI above its normal pressure.

1. Shut off the pump.
2. Close valves* (*optional: suction & return valves).
3. Open air relief valve.
4. Open drain plug (located at the base of the filter body).
5. Depress safety latches (located on the underside of the locking ring handles) and unscrew locking ring in a counter-clockwise direction. Remove lid from filter body.
6. Lift out filter element and clean as instructed in “Preventative Maintenance” section of this manual.

Re-Installing Cartridge Element

1. Clean debris from bottom of filter tank.
2. Replace element evenly on the collector hub in bottom of the filter body.
3. Place lid evenly on filter body and turn Easy-Lok™ ring clockwise until the safety latches engage securely.
4. Close and secure drain plug (located at the base of filter body).
5. Proceed as in “Start-Up & Operation”

Preventative Maintenance

Cleaning Cartridge Filter

NOTICE: Clean the cartridge when filter canister pressure reaches 5-7 PSI above the initial system or new cartridge starting pressure.

1. Remove the cartridge element from the filter housing following the directions in the “Cleaning/Removing Cartridge Element” section above.
2. **DO NOT** Pressure wash. Wash the cartridge element inside and out with the Hayward Jet-action Cleaning Wand (EC2024) or a garden hose. Work from top-down, holding the nozzle at a 45-degree angle. All dirt and debris may not be removed with hosing. Brush pleated surface areas and allow to dry.

Vacuumping

Vacuumping can be performed directly into the filter whenever needed. For fastest results, clean the filter before and after each vacuumping. For heavy spring clean ups, we recommend using a Hayward SP0727 diverter valve to bypass the filter and accelerate the clean up process. Consult your local Hayward dealer for a detailed explanation.

Winterization

In areas where sub-freezing temperatures can be expected, the filter should be drained and/or removed from its operating location and stored indoors. Clean the cartridge element at the end of the pool season by using the Hayward Jet-action Cleaning Wand (EC2024) or a garden hose. (See “Cleaning Cartridge Filter” instructions in this manual).

TROUBLE SHOOTING		
Problem	What to Look For	Treatment
Dirty, clogged, or abused element	Dirt, debris, or tear in pleats or folds	Clean or replace element
Oversized pump - Produces excessive flow rates and/or pressures	Flattened pleats or folds; Embedded dirt or debris into the filter material; Breaking of internal core of the element; Breaking or splitting of the end plates of the element	Re-size pump
Very dirty pool water	Algae buildup on the pool walls	Frequent cartridge cleaning or replacement; Consult professional pool company for pool chemistry instructions.

REPLACEMENT PARTS			
REF NO	Part No.	Description	No. Req
1	ECX27091	Pressure Gauge	1
2	CCX1000I	Threaded Adaptor	1
3	CCX1000V	Air Relief Assy	1
4	CCX1000D	Lock Ring Assy	1
5	CCX1000H	Lock Ring Latch	2
6a	CCX1000C	100 Filter Lid w/ Lock Ring	1
6b	CCX1500C	150 Filter Lid w/ Lock Ring	1
7	CCX1000N	Adapter Nut	2
8a	CCX1000RE	Cartridge Element	1
8b	CCX1500RE	Cartridge Element	1
9	CCX1000B	Filter, Lower Body	1
10	SP1480BLK	Self Aligning Union (Black)	1
11		Pump	1
12	CCX1000A	Base, Standard	1
13	SP1022CBLK	Drain Plug w/O-ring	1
14	CCX1000G	O-ring, Body	1
15	SPX1500W	O-ring	1
16	CCX1000Z5	O-Ring set	1
17	SP1500UNP AK1	Union Connector (Optional)	1
18	SP1484	Self-Aligning Union, (Optional)	1

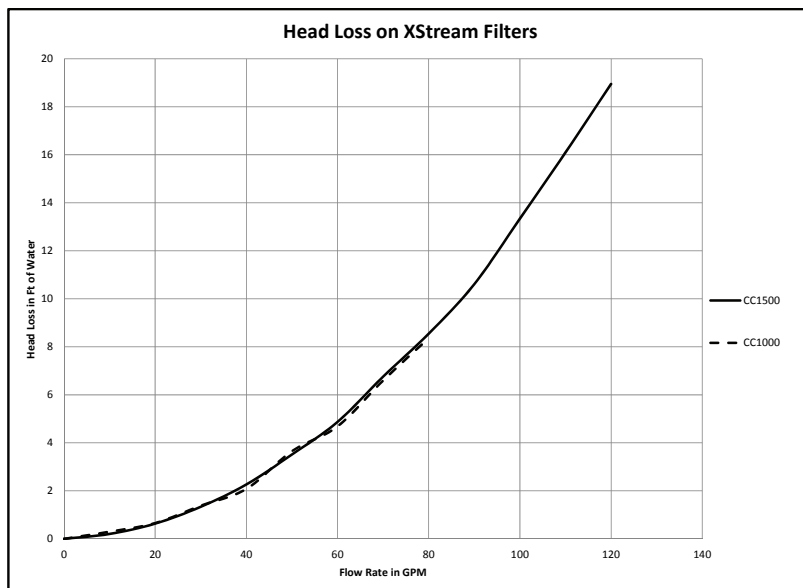
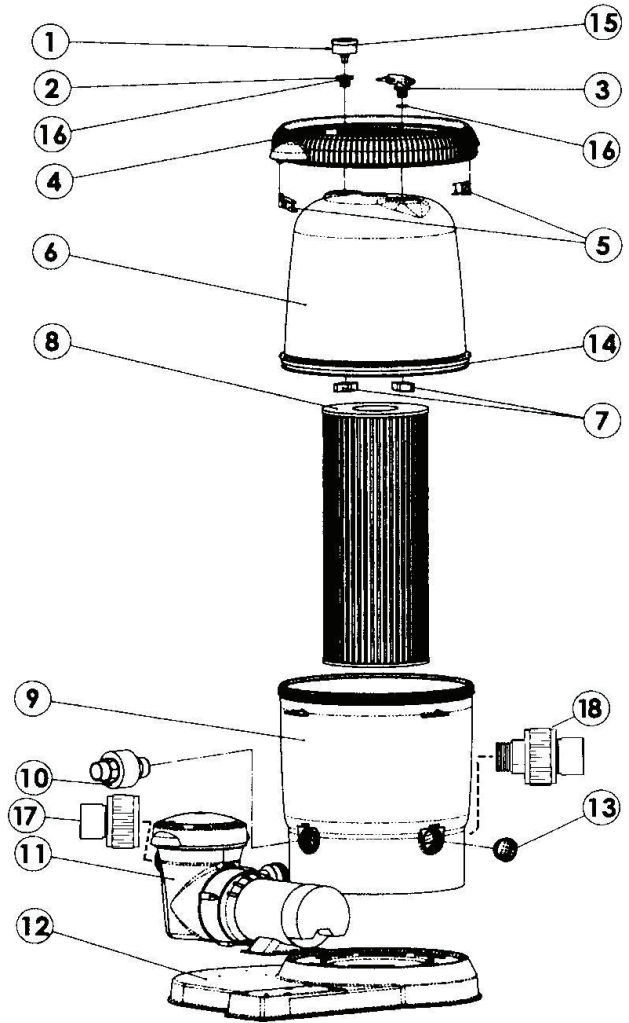



HAYWARD®

PRODUCT REGISTRATION

(Retain For Your Records)

DATE OF INSTALLATION _____

▲ Retain this Warranty Certificate (upper portion) in a safe and convenient location for your records.

HAYWARD® Pool Products Limited Warranty

To original purchasers of this equipment, Hayward Pool Products, Inc. warrants its products to be free from defects in materials and workmanship for a period of ONE (1) year from the date of purchase, when used in single family residential applications.

The limited warranty excludes damage from freezing, negligence, improper installation, improper use or care or any Acts of God. Parts that fail or become defective during the warranty period shall be repaired or replaced, at our option, within 90 days of the receipt of defective product, barring unforeseen delays, without charge.

Proof of purchase is required for warranty service. In the event proof of purchase is not available, the manufacturing date of the product will be the sole determination of the purchase date.

To obtain warranty service, please contact the place of purchase or the nearest Hayward Authorized Service Center. For assistance on your nearest Hayward Authorized Service Center please visit us at www.hayward.com.

Hayward shall not be responsible for cartage, removal, repair or installation labor or any other such costs incurred in obtaining warranty replacements or repair.

The Hayward Pool products warranty does not apply to components manufactured by others. For such products, the warranty established by the respective manufacturer will apply.

The express limited warranty above constitutes the entire warranty of Hayward Pool Products with respect to its' pool products and is in lieu of all other warranties expressed or implied, including warranties of merchantability or fitness for a particular purpose. In no event shall Hayward Pool products be responsible for any consequential, special or incidental damages of any nature.

Some states do not allow a limitation on how long an implied warranty lasts, or the exclusion of incidental or consequential damages, so the above limitation may not apply to you. This warranty gives you specific legal rights, and you may also have other rights, which vary from state to state.

Hayward Pool Products
620 Division Street
Elizabeth, NJ 07207

*Supersedes all previous publications.



DETACH HERE: Fill out bottom portion completely and mail within 10 days of purchase/installation or register online.

XStream™ Cartridge Filter

Warranty Card Registration

Register online at www.hayward.com

Please Print Clearly:

First Name _____ Last Name _____

Street Address _____

City _____ State _____ Zip _____

Phone Number _____ Purchase Date _____

E-Mail Address _____

Serial Number _____

Model Number _____

Pool Capacity _____ (U.S. Gallons)

If your product contains components that have individual serial numbers, it is not necessary to complete warranty registration for those individual components. Instead, complete warranty registration only for the overall product, using the serial number that is located on the outside of the product packaging.

Please include me on all e-mail communications regarding Hayward® Equipment or promotions.

Mail to: Hayward Pool Products, 620 Division Street, Elizabeth, NJ 07207

Attn: Warranty Dept

Or REGISTER YOUR WARRANTY ON-LINE AT WWW.HAYWARD.COM

Years Pool has been in service	
< 1 year	1-3 4-5 6-10 11-15 >15
Purchased from _____	
Builder	Retailer Pool Service Internet/Catalog
Company Name _____	
Address _____	
City _____	State _____ Zip _____
Phone _____	
Type of Pool:	
Concrete/Gunite	Vinyl Fiberglass
Other _____	
New Installation	
Replacement	
Installation for:	
In Ground	Above Ground Spa



Hayward is a registered trademark and XStream is a trademark of Hayward Industries, Inc.
© 2015 Hayward Industries, Inc.